

**DOOR SPECIFICATION**

- custom manufacturing
- leaf without rebate
- rigid steel frame, rectangular frame
- leaf thickness 65 mm
- leaf construction of 2 steel skins 0.9 mm
- paper honeycomb infill
- powder coating, RAL palette

**DOOR SIZES**

- width=1220 (+15%max); Height=2300 (+15%max)

**CERTIFICATES**

- Fire resistance test report no. 533452  
– Warrington Fire UK
- Certificate of Constancy of Performance  
– under preparation

**STANDARD EQUIPMENT**

- 2 pcs of non-adjustable stainless steel hinges (optional: 2 pcs of stainless steel 3D hinges)
- Adjufix screws for faster installation
- set of stainless steel handles / push plate
- reinforcement for door closer
- door closer

**ALTERNATIVE EQUIPMENT**

- locks, panic locks, handles, panic bars, electric strike, maglocks
- other alternative equipment and other door features on request

**OPTIONAL DOOR CONSTRUCTION**

- glazed with rectangular or round glazing
- single or double glass

**→ DRAWINGS**

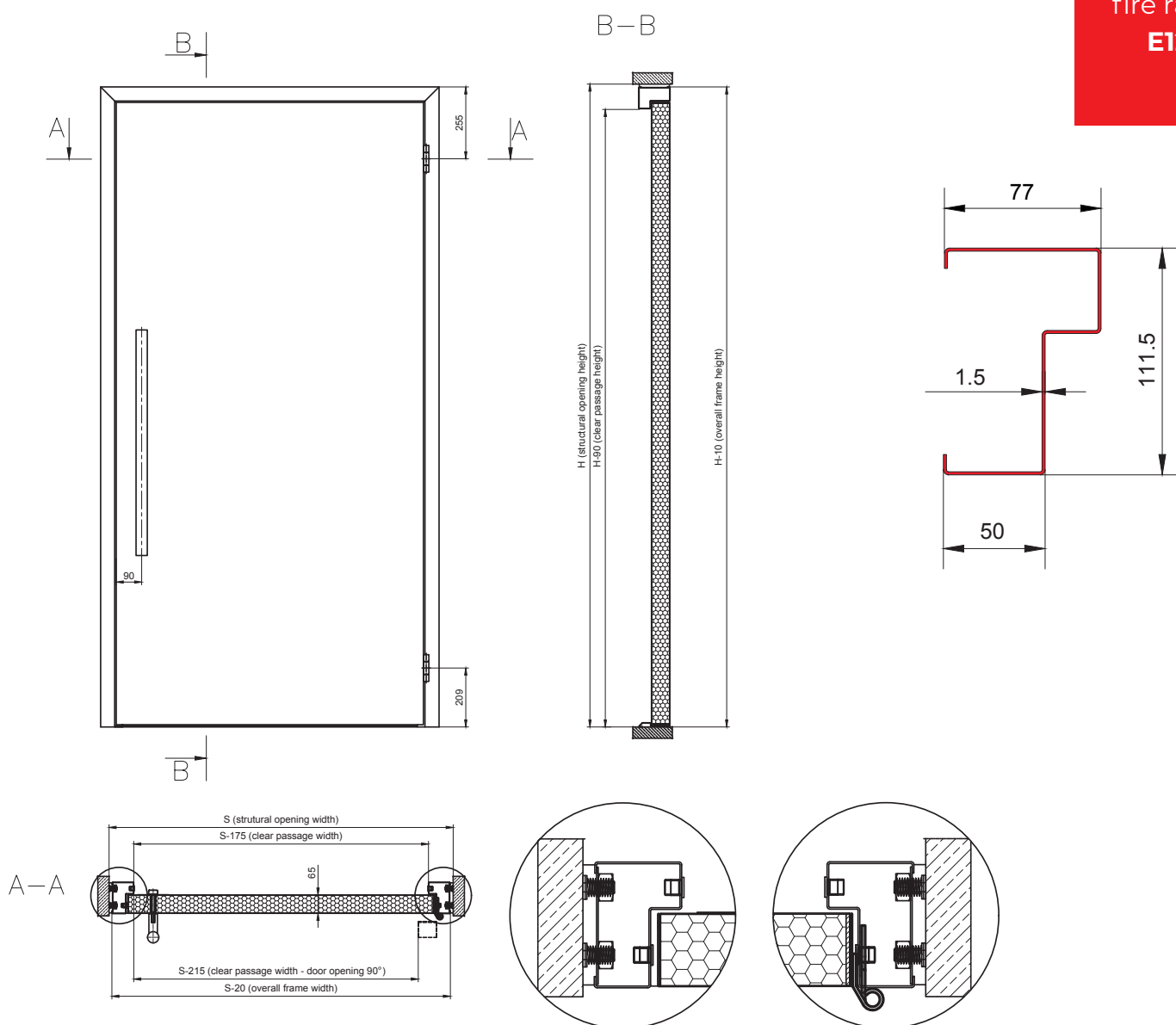

fire rating  
**E120**

**DOOR SPECIFICATION**

- custom manufacturing
- leaf without rebate
- rigid steel frame, rectangular frame
- leaf thickness 65 mm
- leaf construction of 2 steel skins 0.9 mm
- paper honeycomb infill
- powder coating, RAL palette

**DOOR SIZES**

- width=2350 (+15%max); Height=2300 (+15%max)

**CERTIFICATES**

- Fire resistance test report no. 541343
  - Warrington Fire UK
- Certificate of Constancy of Performance
  - under preparation

**STANDARD EQUIPMENT**

- 2 pcs of non-adjustable stainless steel hinges (optional: 2 pcs of stainless steel 3D hinges)
- Adjufix screws for faster installation
- set of stainless steel handles / push plate
- reinforcement for door closer
- door closer + closing sequence controller

**ALTERNATIVE EQUIPMENT**

- locks, panic locks, handles, panic bars, electric strike, maglocks
- other alternative equipment and other door features on request

**OPTIONAL DOOR CONSTRUCTION**

- glazed with rectangular or round glazing
- single or double glass

→ **DRAWINGS**

fire rating  
**E120**

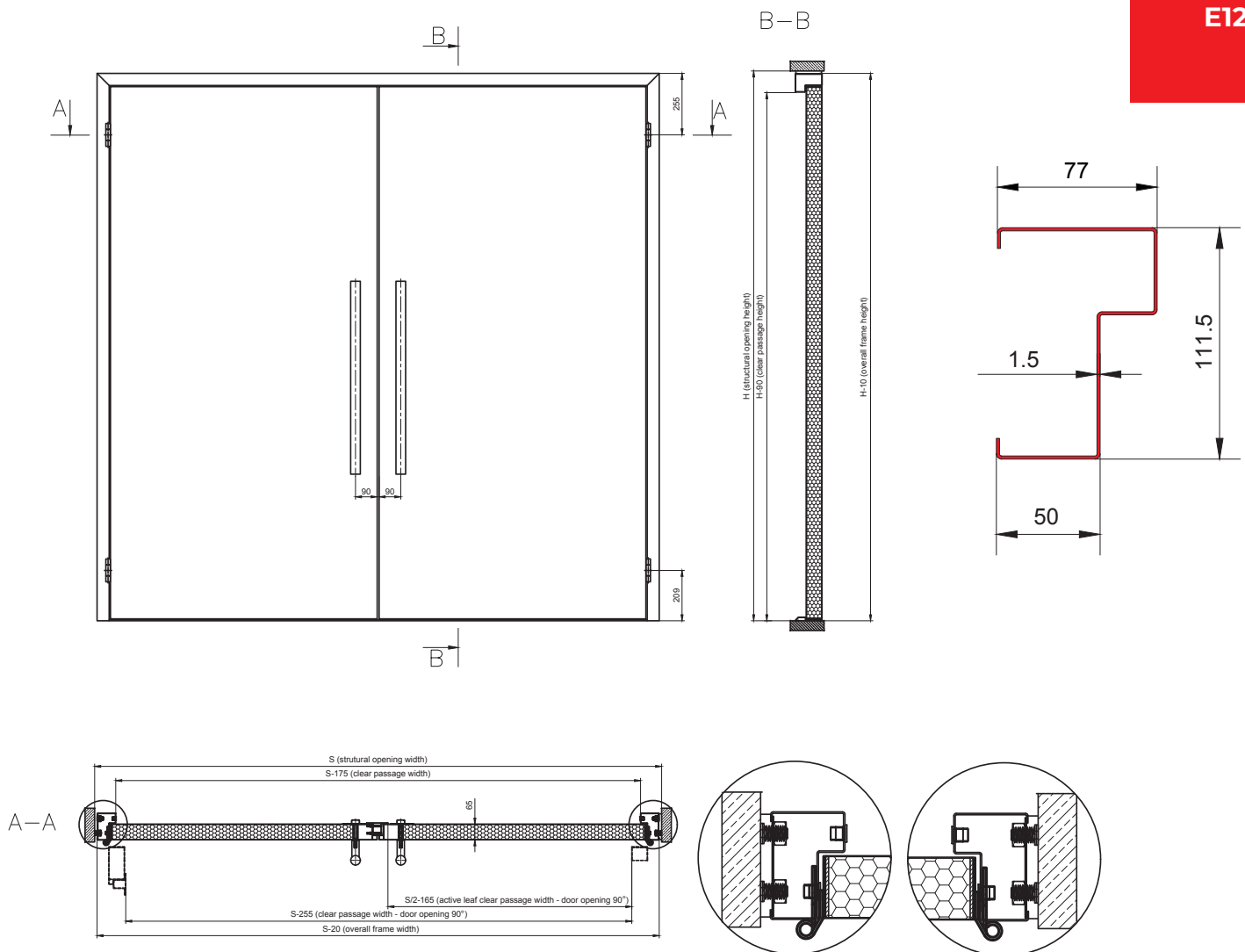

- Glass sight size: 200 x 800 mm (-50%)
- Glass reference: Contraflam Lite 120 (5/5) – Vetrotech Saint Gobain.
- Glass frame: galvanized steel 1.5 mm.

## → DRAWINGS

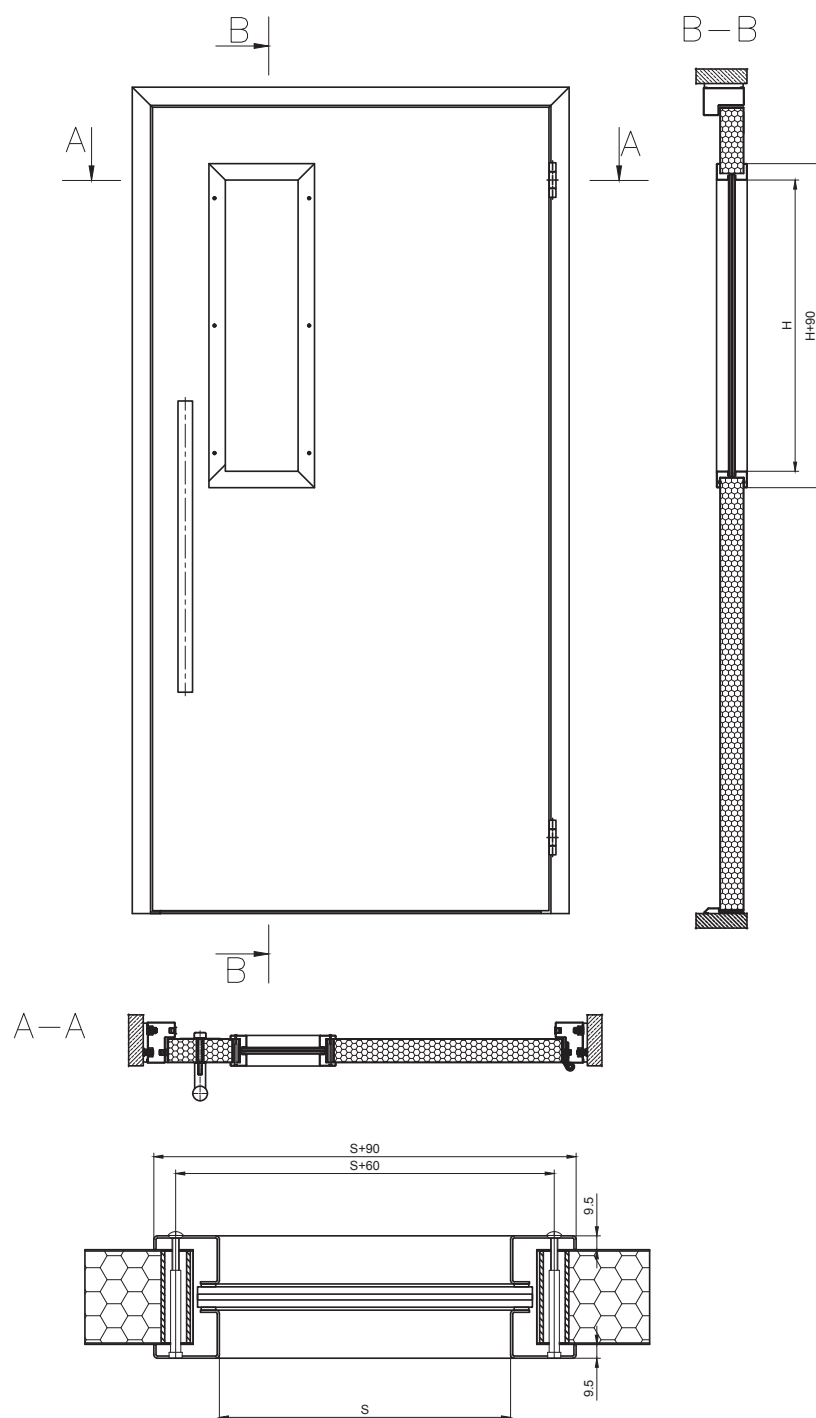
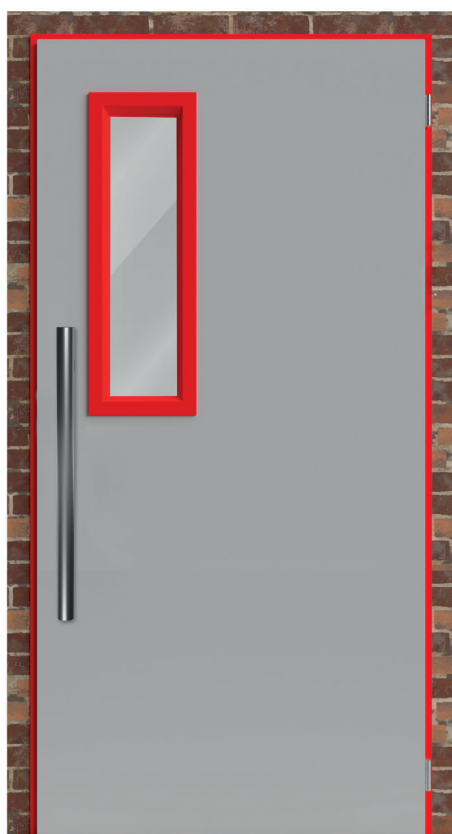

- Overall Size:  
300 – 1800 mm long (standard 800 mm) x 40 mm diameter
- Material: Stainless Steel 1.4301 (304)

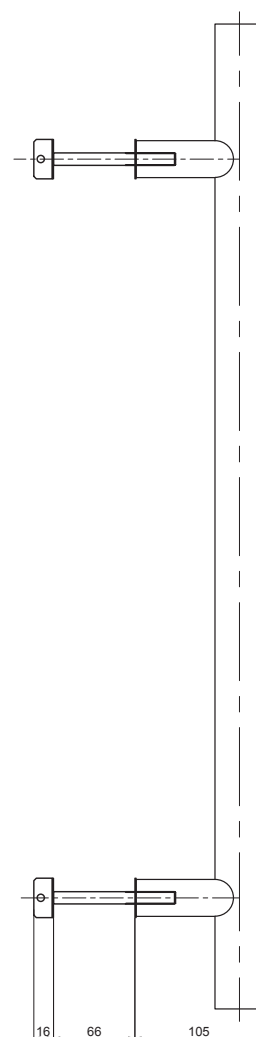
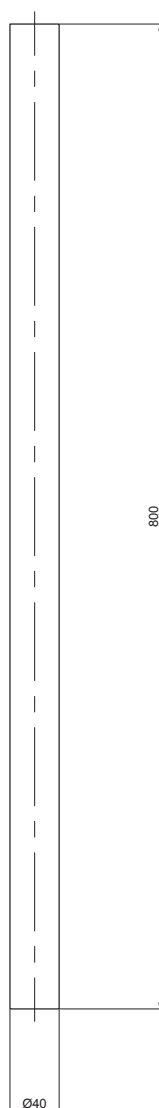

→ DRAWINGS

## HANDLE-HANDLE on oval shield



- ironmongery: handle-handle type U-form on oval shield
- construction: main shield made of zinc coated steel, external shield made of stainless steel 1.4301
- lever handle made of stainless steel 1.4301
- handle equipped with tensing spring for automatic return to horizontal position
- square of handle: 9 mm
- distance: 72 mm
- shield available with hole for PZ cylinder or blind

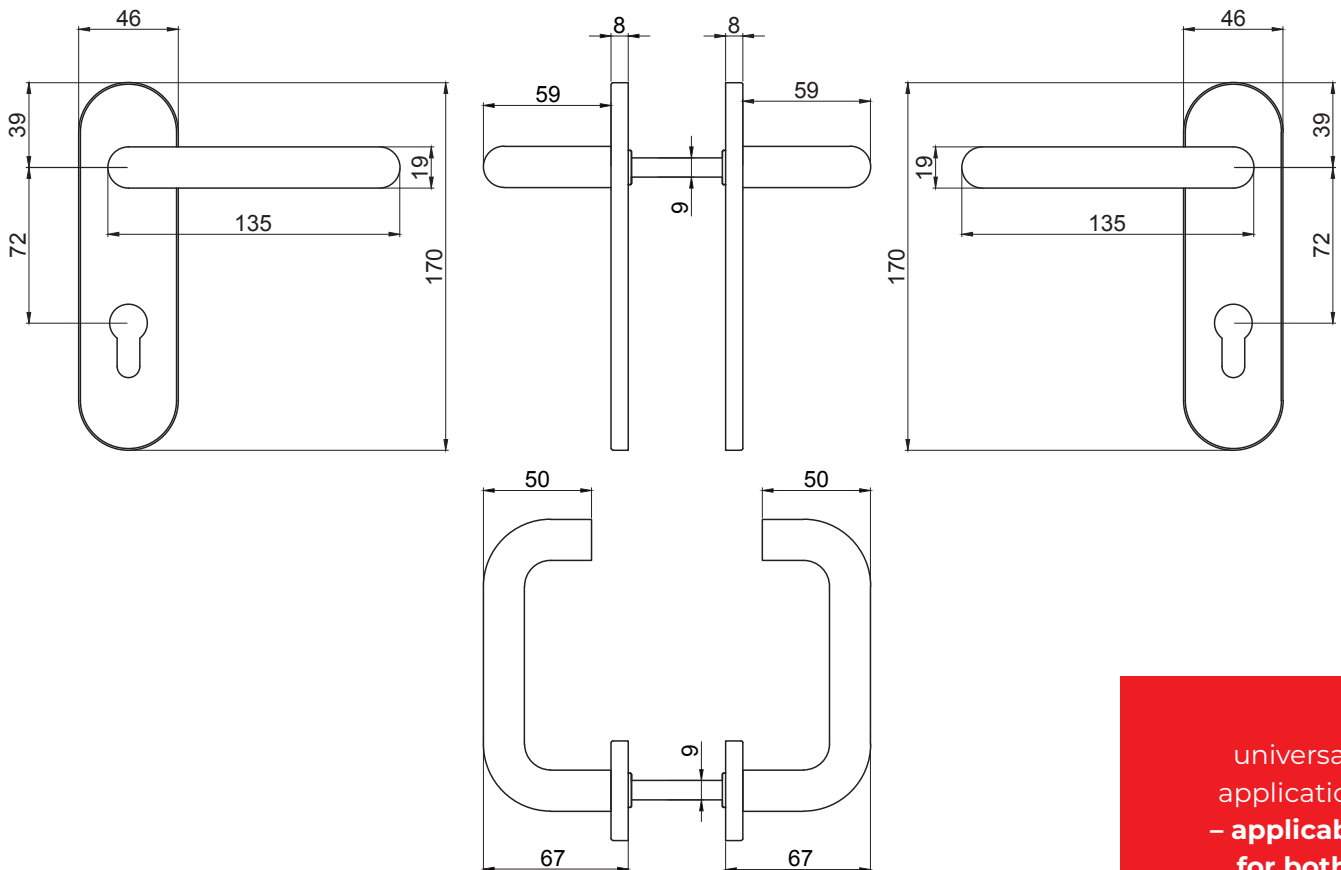

→ cross sections and sizes

universal  
application  
– **applicable**  
for both  
right and left  
handed doors

## HANDLE-HANDLE on round shield

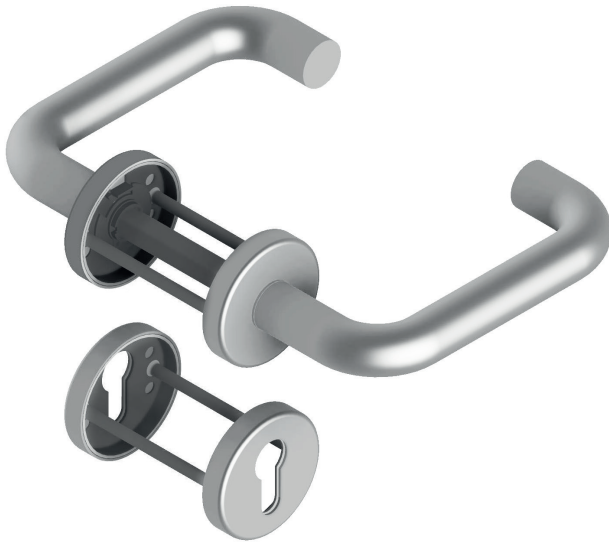

- ironmongery: handle-handle type U-form on round shield
- universal application – applicable for both right and left handed doors
- construction: main shield made of zinc coated steel, external shield made of stainless steel 1.4301
- lever handle made of stainless steel 1.4301
- handle equipped with tensing spring for automatic return to horizontal position
- square of handle: 9 mm
- distance: 72 mm
- shield available with hole for PZ cylinder or blind

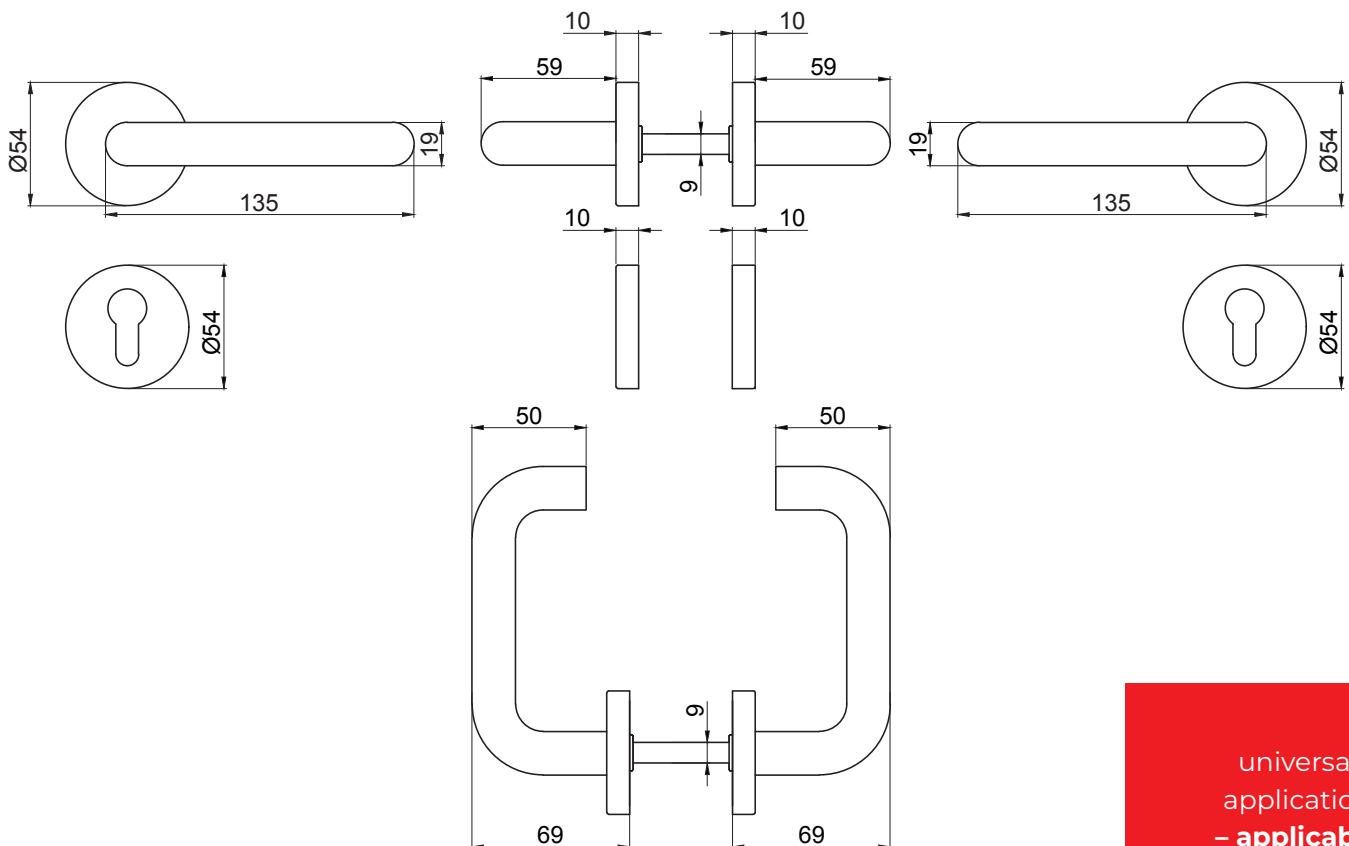

→ cross sections and sizes

universal  
application  
– **applicable**  
for both  
right and left  
handed doors

## HANDLE-KNOB on oval shield



- ironmongery: handle-knob type U-form on oval shield
- construction: main shield made of zinc coated steel, external shield made of stainless steel 1.4301
- handle equipped with tensing spring for automatic return to horizontal position
- square of handle: 9 mm
- distance: 72 mm
- shield available with hole for PZ cylinder or blind

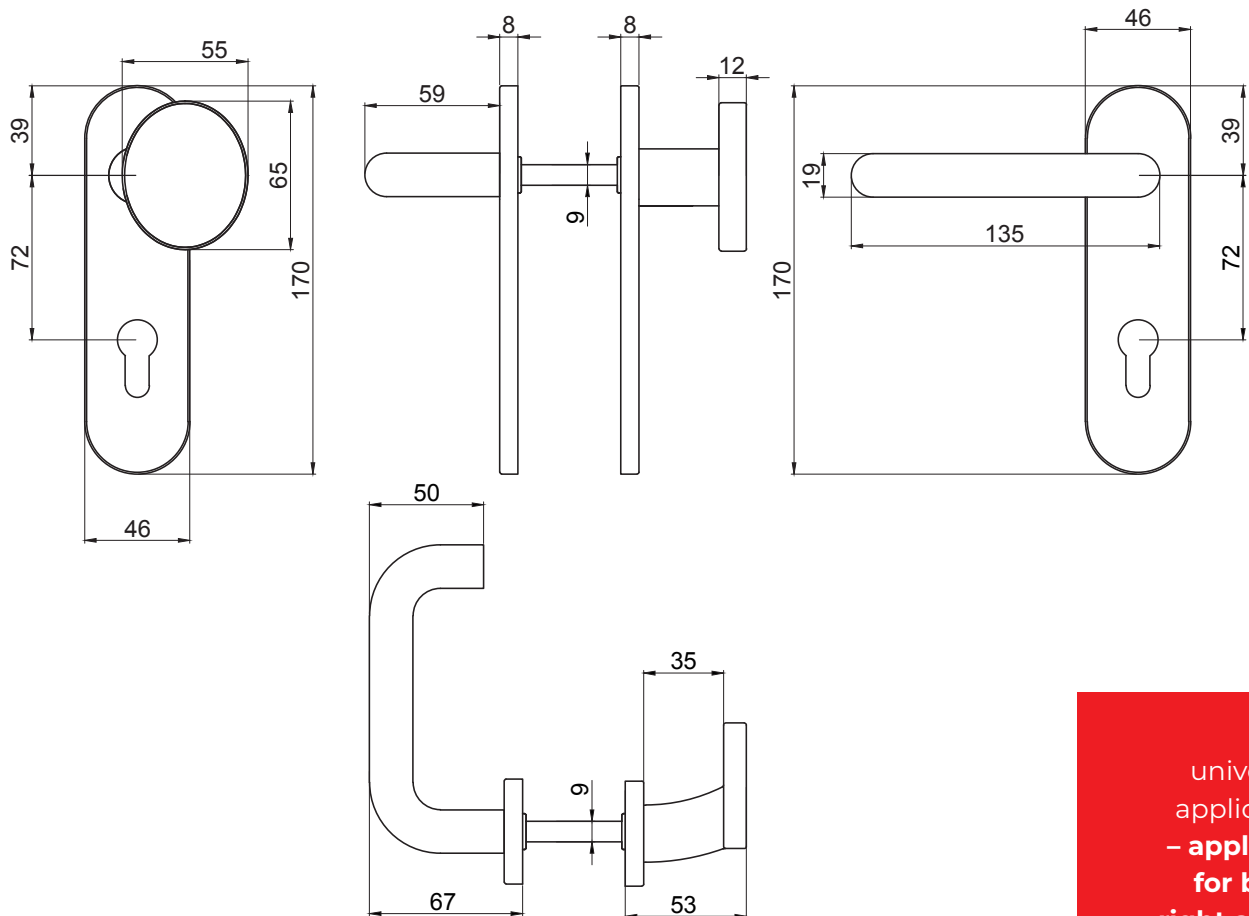

→ cross sections and sizes

universal  
application  
– **applicable**  
for both  
right and left  
handed doors

## HANDLE-KNOB on round shield



- ironmongery: handle-knob type U-form on round shield
- application – defined as right handed or left handed
- construction: main shield made of zinc coated steel, external shield made of stainless steel 1.4301
- lever handle made of stainless steel 1.4301
- handle equipped with tensing spring for automatic return to horizontal position
- square of handle: 9 mm
- distance: 72 mm
- shield available with hole for PZ cylinder or blind

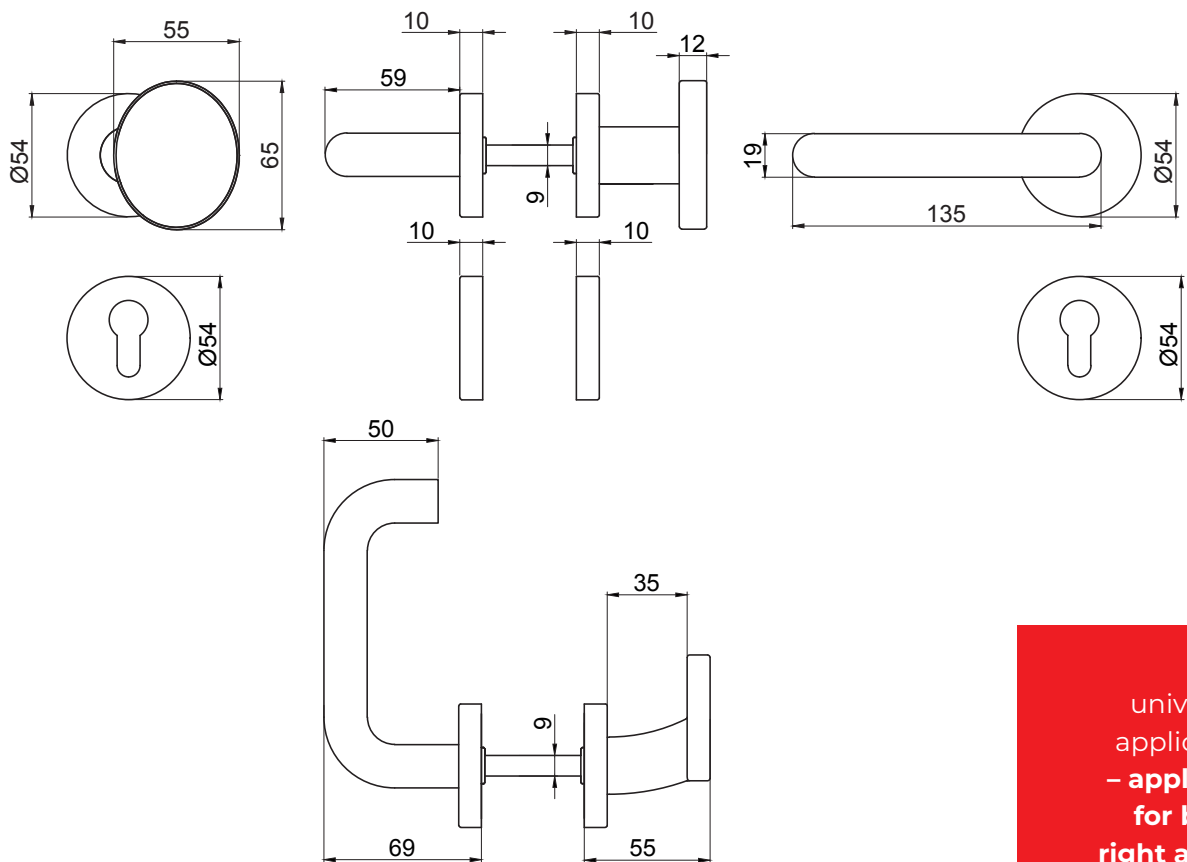

→ cross sections and sizes

universal  
application  
– **applicable**  
for both  
right and left  
handed doors



## HANDLE-HANDLE TYPE L-FORM on oval shield



- ironmongery: handle-handle type L-form on oval shield
- universal application – applicable for both right and left handed doors
- construction: main shield made of zinc coated steel, external shield made of stainless steel 1.4301
- lever handle made of stainless steel 1.4301
- handle equipped with tensing spring for automatic return to horizontal position
- square of handle: 9 mm
- distance: 72 mm
- shield available with hole for PZ cylinder or blind

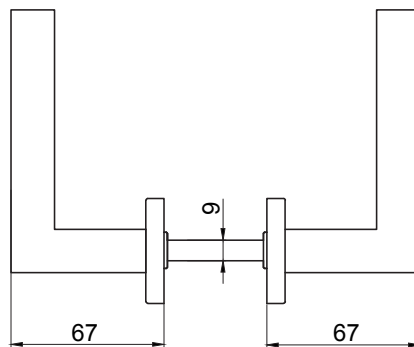
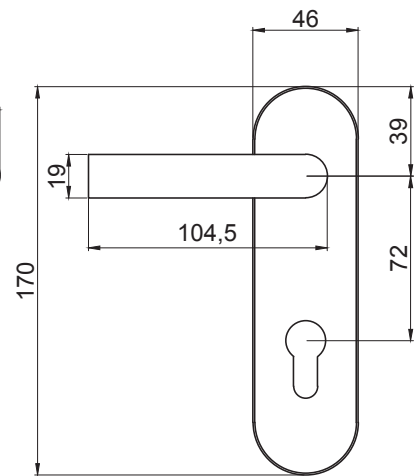
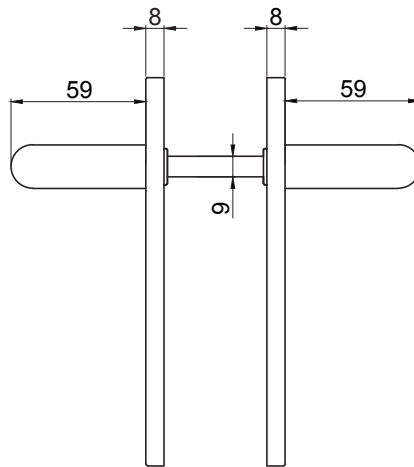
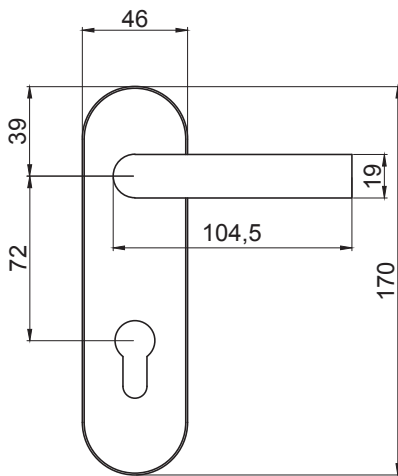

→ cross sections and sizes

universal  
application  
– **applicable**  
for both  
right and left  
handed doors

## HANDLE-HANDLE TYPE L-FORM on round shield

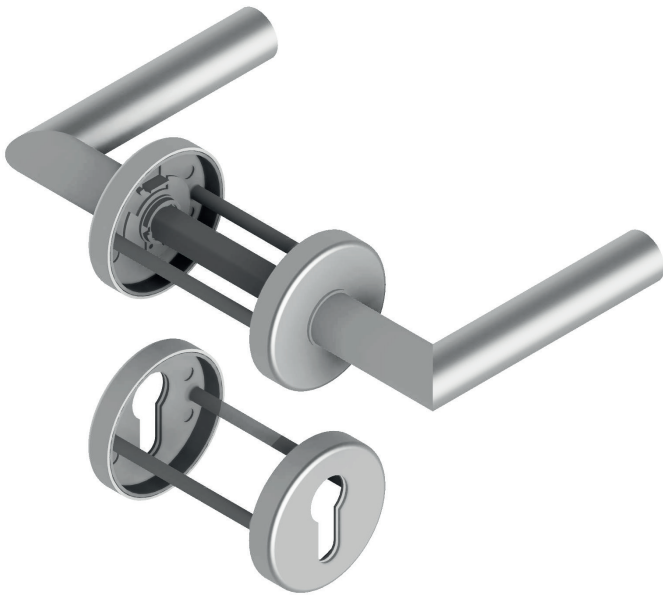

- ironmongery: handle-handle type L-form on round shield
- universal application – applicable for both right and left handed doors
- construction: main shield made of zinc coated steel, external shield made of stainless steel 1.4301
- lever handle made of stainless steel 1.4301
- handle equipped with tensing spring for automatic
- return to horizontal position
- square of handle: 9 mm
- distance: 72 mm
- shield available for with hole for PZ cylinder and blind

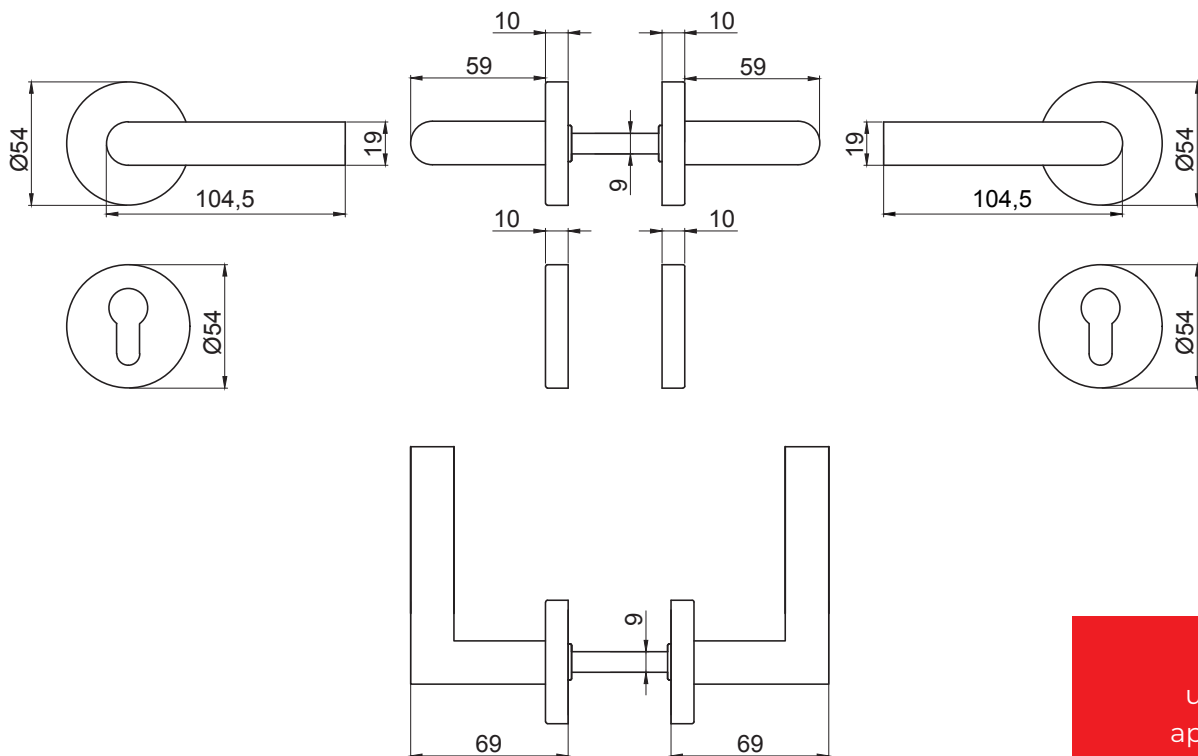

→ cross sections and sizes

universal  
application  
– **applicable**  
for both  
right and left  
handed doors

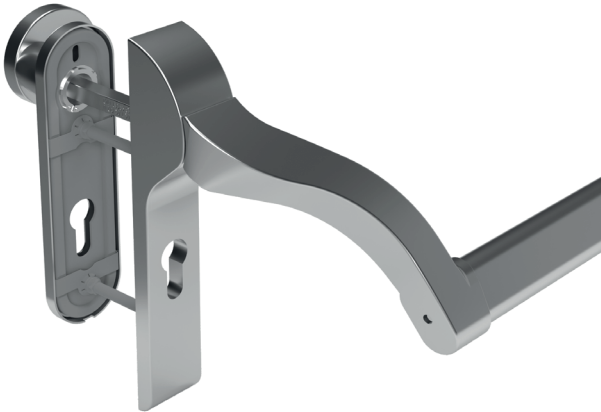

- DFM standard panic bar EPN 900 IV (Eco Schulte)
- collaborates with mortise panic lock
- intended for doors DFM DS E120 1/2 UK
- standard finish: black PVC
- optional finishes: stainless steel, aluminium
- available sizes of the bar: 900 mm, 1150 mm and 1500 mm (to be cut on site to required length, corresponding with the width of the door leaf)
- distance: 72 mm, square of handle: 9 mm
- available sets of application: panic bar-handle, panic bar-knob, panic bar-blind door leaf
- intended for evacuation routes in concordance with EN 1125, to complete with a compatible panic lock
- available with hole for PZ cylinder or without
- standard turning angle: 45 degrees

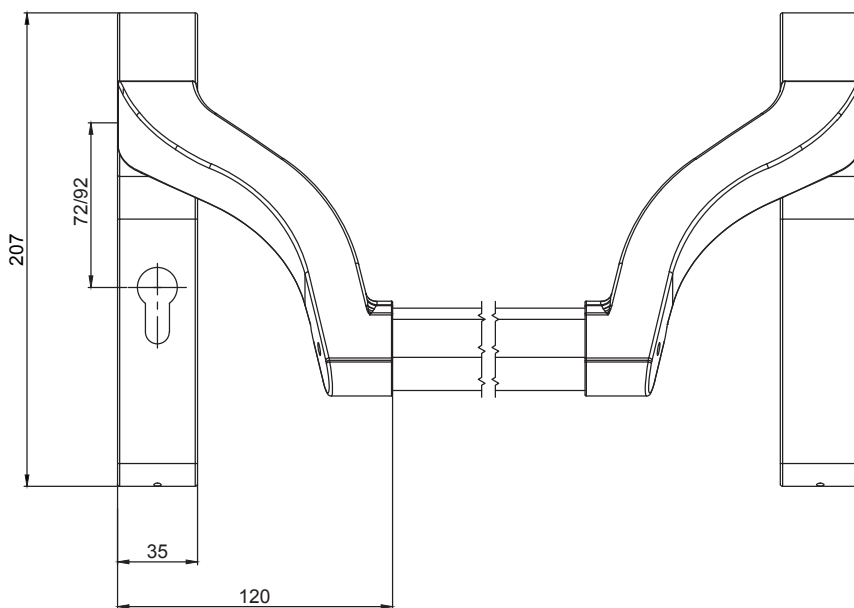

→ view and sizes

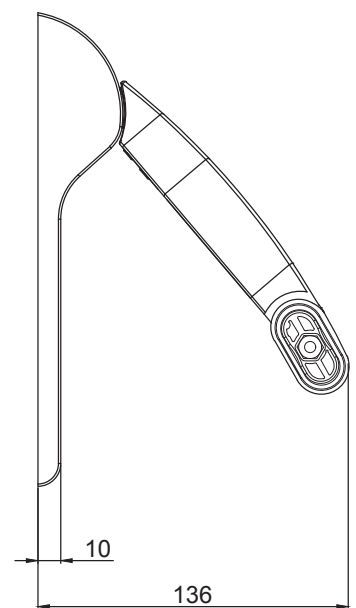

→ cross section and sizes

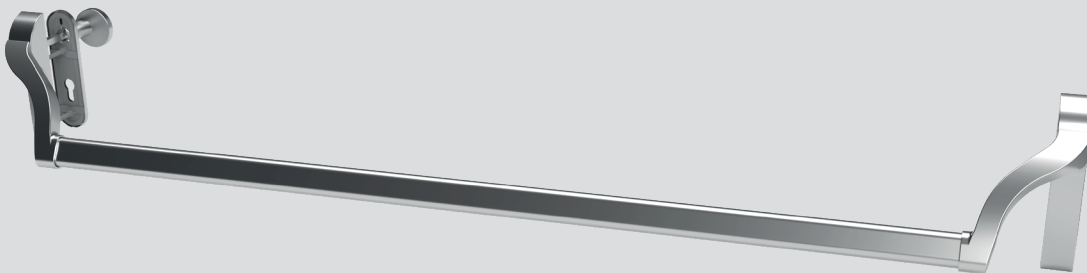

universal panic bar  
for left and right  
handed doors



- thickness of material: 3 mm
- teflon bearings - maintenance not required
- screwed to the leaf and the frame; non-adjustable
- DFM designed: installation anchors led through holes in hinge blades to assure rigid assembly in wall
- Certificate of Constancy of Performance according to EN 1925 standard

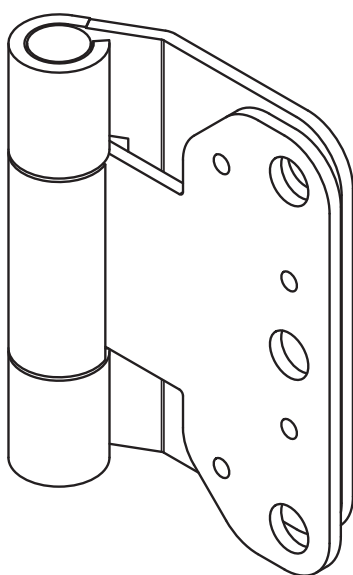

→ non-adjustable hinge,  
size

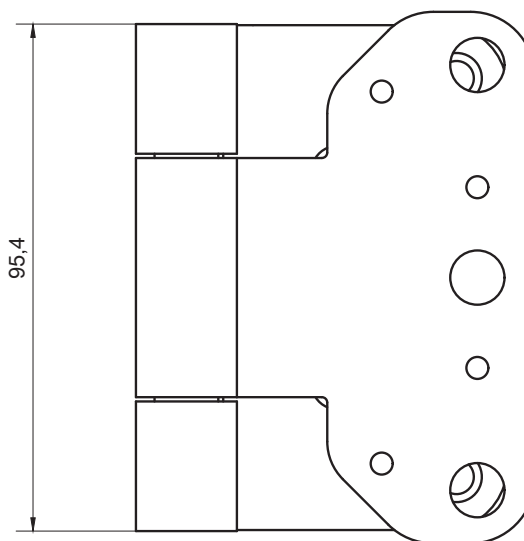

→ non-adjustable hinge,  
view

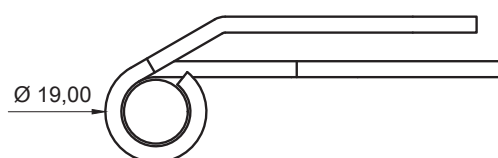

→ horizontal section



- standard 1-point lock GBS 81 (Eco Schulte) for doors DFM DS E120 - 1/2 UK
- construction: mortise, latch and deadbolt, PZ cylinder, Wechsel function
- made of galvanized steel, stainless steel 24 mm fore-plate
- size (dormmass): 65 mm/72 mm, square: 9 mm
- compatible with fittings: handle-handle, handle-knob
- Certificate of Constancy of Performance according to EN 12209 standard

application  
defined:  
**DIN left**  
**DIN right**

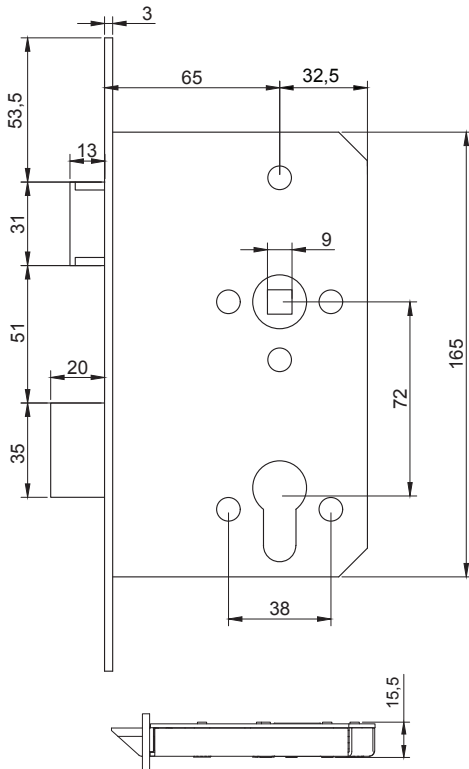

→ panic lock – sizes

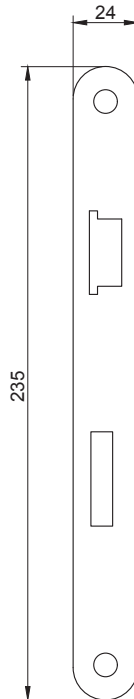

→ fore-plate of lock

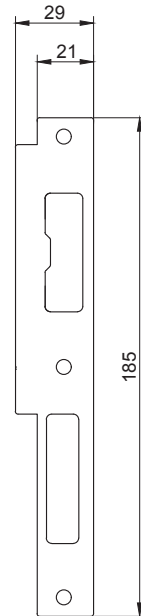

→ strike plate

## PANIC LOCK, function B, D, E



- 1-point panic lock GBS 92 (Eco Schulte) for doors DFM DS E1201/2 UK;
- for single-leaf doors, or double-leaf doors with panic
- function on active leaf only
- panic functions implemented: B, D, and E
- intended for evacuation routes:
  - as panic locking (EN 1125 standard)
  - and emergency exit locking (EN 179)
- construction: mortise, made of galvanized steel, with latch and deadbolt, PZ cylinder
- size (dormmass): 65 mm/72 mm, square: 9 mm
- made of galvanized steel, stainless steel 24 mm fore-plate
- compatible with fittings: handle-handle, handle-panic bar,
- knob-panic bar, knob-handle
- Certificate of Constancy of Performance according to EN 12209 standard

application  
defined:  
**DIN left**  
**DIN right**

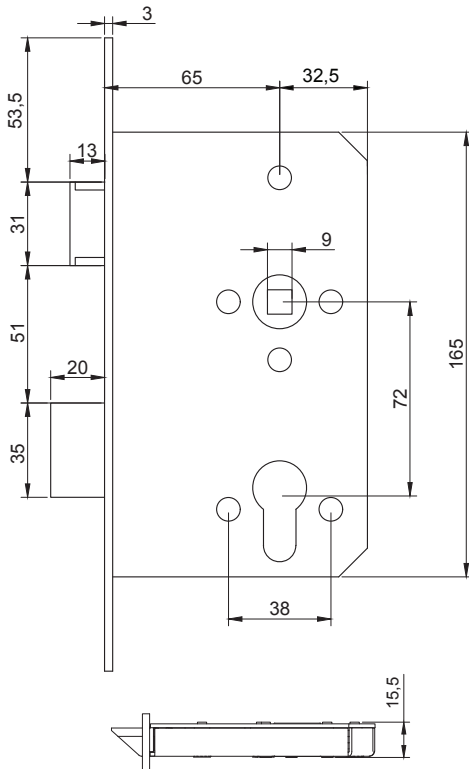

→ panic lock – sizes

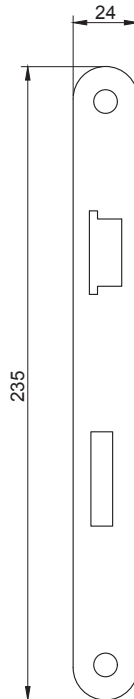

→ fore-plate of lock

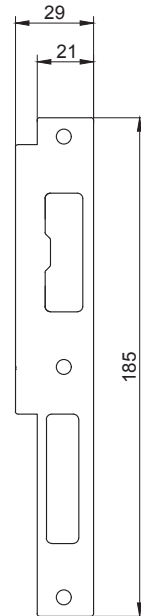

→ strike plate



- set of a 1-point panic lock GBS 93 and its counter lock GBS 94 (Eco Schulte) with panic function on both door leaves for DFM DS E120 - 1/2 UK;
- panic functions implemented: B, D, and E
- intended for evacuation routes:  
as panic locking (EN 1125 standard)  
and emergency exit locking (EN 179)
- construction: mortise, made of galvanized steel, with latch and deadbolt, PZ cylinder; stainless steel 24 mm fore-plate
- size of lock GBS 93 (dormass): 65 mm/72 mm, square: 9 mm

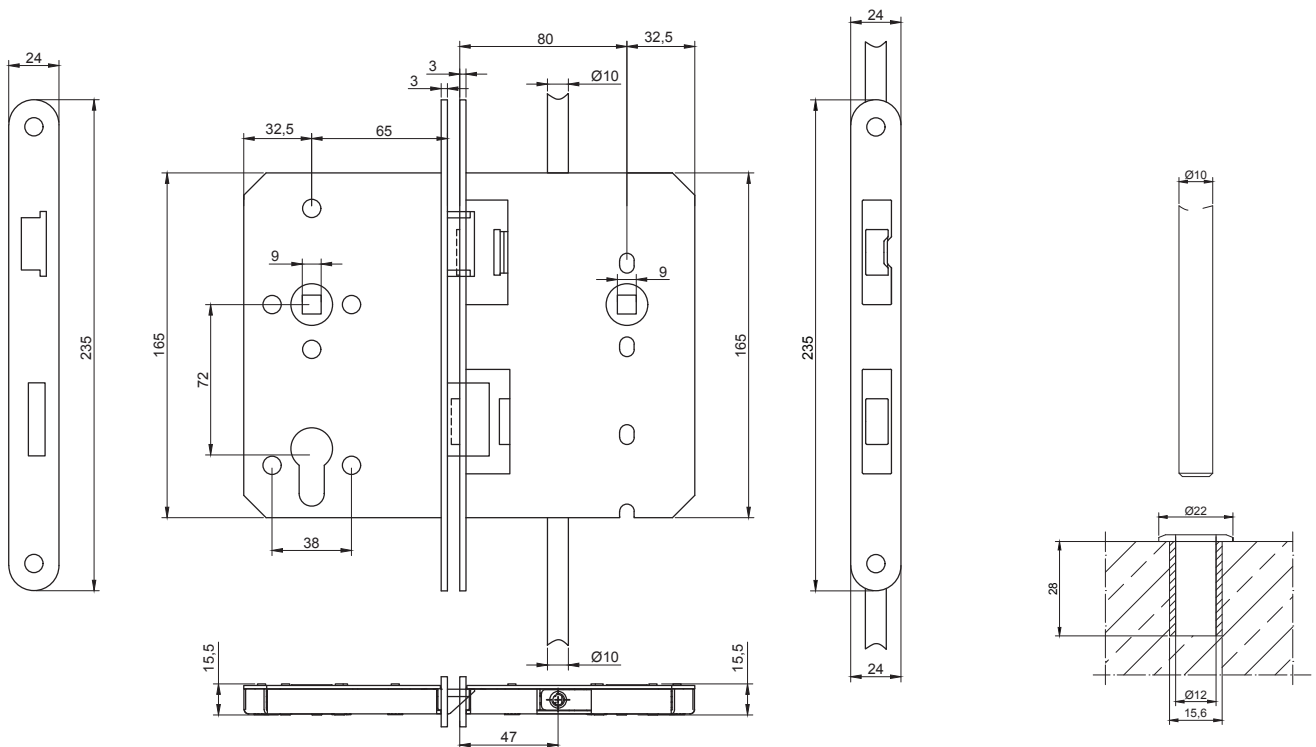

→ panic lock

→ counter lock

→ floor sleeve

FLUSH BOLT on passive door leaf

- The flush bolt is a semi-automatic set consisting of closing mechanism fitted with lever (4), steel rods (3,5), semi-automatic latch (2) and floor sleeve (6).
- The lever and foreplate of mechanism are made of stainless steel, the mechanism is made of zinc coated steel.
- The passive leaf is locked automatically by steel rods entering up into top of door frame and down in the floor (into floor sleeve).
- It is unlocked by manual lifting of the lever, effected by withdrawal of rods into the mechanism.

semi-automatic  
mortise flush bolt  
(espagnolette)

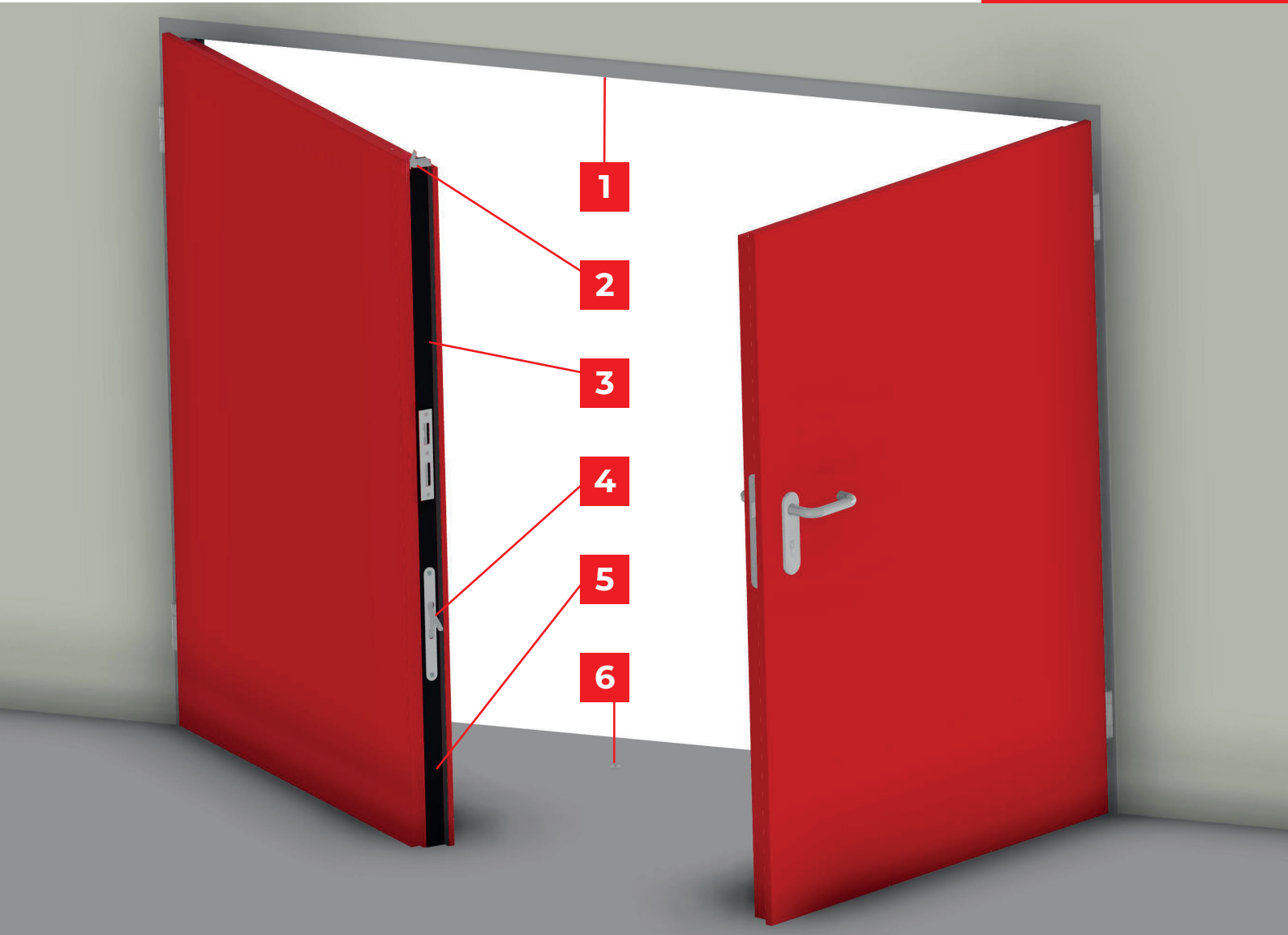

FLUSH BOLT on passive door leaf

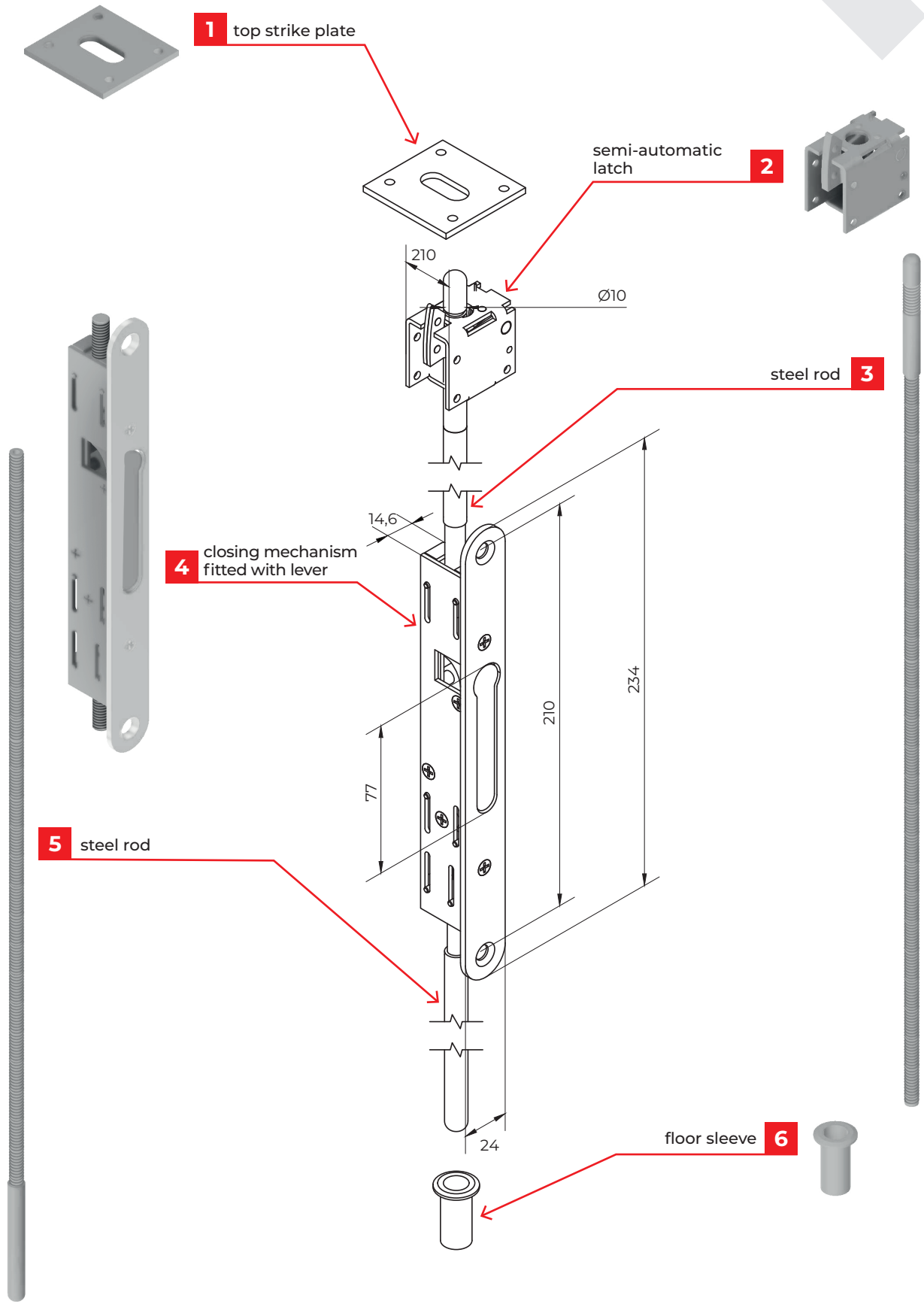





- electric strike plate series XSHD-C (Bira), other models at request
- mode of work-fail secure (the latch of electric strike plate is stiff without power supply)
- voltage 12 or 24 VDC
- adjustment range 3,5 mm
- co-operates with main lock (installed at height of main lock)
- applicable ironmongery: handle-knob, handle-pull bar
- complete with cable loop in passive door leaf in the case of double leaf doors
- electric strike plate is handed for right or left door

available in  
**12V or 24V**

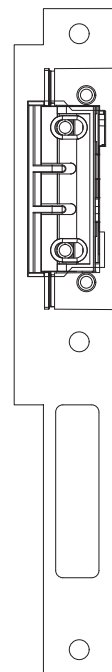
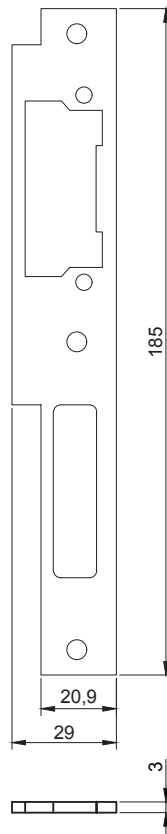
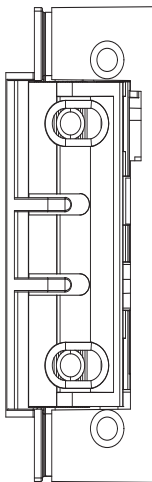

→ sizes and sections